

B AC Motors

Reversible Motor 6W(□70mm)

6W

Reversible Motor
6W(□70mm)

Motor Specification

Model		Output	Voltage	Frequency	Poles	Duty	Starting Torque		Rated Load				Capacitor
Lead Wire Type	Terminal Box Type						kgfcm	N.m	Speed	Current	Torque		
7RDG□-6G(-T): Gear Type Shaft 7RDD□-6(-T): D-Cut Type Shaft		W	V	Hz					r/min	A	kgfcm	N.m	
7RDGA-6G	7RDGA-6G-T	6	1φ110	60	4	30min.	0.64	0.064	1600	0.29	0.50	0.050	3.0 / 250
7RDGD-6G	7RDGD-6G-T	6	1φ220	60	4	30min.	0.85	0.085	1600	0.16	0.60	0.060	1.0 / 450
7RDGE-6G	7RDGE-6G-T	6	1φ220	50	4	30min.	0.61	0.061	1250	0.13	0.68	0.068	0.8 / 450
			1φ240				0.75	0.075		0.14	0.76	0.076	

1) Enter the phase & voltage code in the box (□) within the motor model name.

2) All models contain a built-in thermal protector.

3) Gear Type Shaft is for attaching Gearbox and D-Cut Type Shaft is for using motor only.

Max. Permissible Torque at Output Shaft of Gearbox

60Hz

Motor Model	Gearbox Model	Gear Ratio	3	3.6	6	7.5	9	12.5	15	18	25	30	36	50	60	75	90	100	120	150	180
			r/min	600	500	300	240	200	144	120	100	72	60	50	36	30	24	20	18	15	12
7RDG□-6G	7GBK□BMH	kgfcm	1.5	1.8	3.0	3.7	4.5	6.2	7.5	9.0	11.3	13.5	14.7	20.4	24.5	30.6	36.7	40.8	49.0	50.0	50.0
		N.m	0.15	0.18	0.29	0.37	0.44	0.61	0.73	0.88	1.10	1.32	1.44	2.00	2.40	3.00	3.60	4.00	4.80	4.90	4.90

50Hz

Motor Model	Gearbox Model	Gear Ratio	3	3.6	6	7.5	9	12.5	15	18	25	30	36	50	60	75	90	100	120	150	180
			r/min	500	416	250	200	166	120	100	83	60	50	41	30	25	20	16	15	12.5	10
7RDG□-6G	7GBK□BMH	kgfcm	1.7	2.0	3.4	4.2	5.1	7.1	8.5	10.2	12.8	15.3	16.6	23.1	27.7	34.7	41.6	46.2	50.0	50.0	50.0
		N.m	0.17	0.20	0.33	0.41	0.50	0.69	0.83	1.00	1.25	1.50	1.63	2.27	2.72	3.40	4.08	4.53	4.90	4.90	4.90

1) Enter the phase & voltage code in the box (□) within the motor model name.

2) Enter the gear ratio in the box (□) within the Gearbox model name.

3) A colored background indicates gear shaft rotation in the same direction as the motor shaft; a white background indicates rotation in the opposite direction.

4) The rotating speed is calculated by dividing the motor's synchronous speed (50Hz: 1,500r/min, 60Hz: 1,800r/min) by the gear ratio. The actual speed is 2~20% less than the displayed value, depending on the size of the load.

Motor Images



Dimensions

MOTOR ONLY

- MOTOR MODEL: 7RDD□-6(-T) (NO FAN)

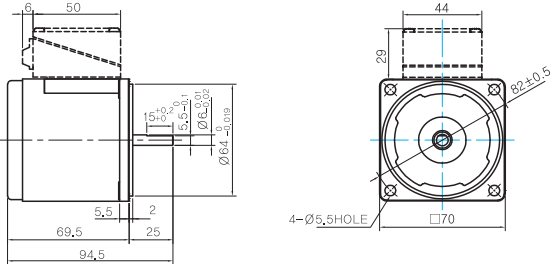

MOTOR OUTPUT SHAFT

MODEL	SPEC
D-CUT TYPE	

GEARED MOTOR

G TYPE GEARBOX

- MOTOR MODEL: 7RDG□-6G (NO FAN)
- GEARBOX MODEL: 7GBK□BMH

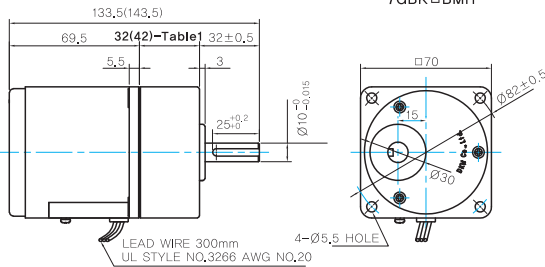

GEARBOX OUTPUT SHAFT

MODEL	SPEC
KEY TYPE	

KEY SPEC

GEARBOX	SPEC
32	
42	

WEIGHT

PART	WEIGHT(Kg)	
MOTOR	0,84	
GEAR BOX	7GBK3BMH ~ 7GBK18BMH	0,36
	7GBK25BMH ~ 7GBK30BMH	0,44
GEAR BOX	7GBK36MH ~ 7GBK180MH	0,5

32(42)-Table1

SIZE(mm)	GEAR RATIO
32	7GBK3BMH - 7GBK18BMH
42	7GBK25BMH - 7GBK180BMH

Connection Diagrams

Lead Wire Type	Terminal Box Type						
	<table border="1" style="width: 100%;"> <thead> <tr> <th>Code</th> <th>Contact Capacity</th> </tr> </thead> <tbody> <tr> <td>SW</td> <td>AC125V 5A min. or AC250V 5A min. (Inductive load)</td> </tr> <tr> <td>R_o, Co</td> <td>R_o=5-200Ω Co=0.1-0.2μF, 200W (400W)</td> </tr> </tbody> </table> <p>* Connect a CR circuit for surge suppression to protect the contact.</p>	Code	Contact Capacity	SW	AC125V 5A min. or AC250V 5A min. (Inductive load)	R _o , Co	R _o =5-200Ω Co=0.1-0.2μF, 200W (400W)
Code	Contact Capacity						
SW	AC125V 5A min. or AC250V 5A min. (Inductive load)						
R _o , Co	R _o =5-200Ω Co=0.1-0.2μF, 200W (400W)						

- The direction of motor rotation is as viewed from the shaft end of the motor.
- CW represents the clockwise direction, while CCW represents the counterclockwise direction.
- During operation it is available to change the rotating direction by turning the switch to CW or CCW.